

S. CHURCH STREET (U.S. HWY 231)
(OPTIONAL - 102' R.O.W.)

LINE TABLE

LINE	DESCRIPTION	WIDTH	DEPTH
1	CONCRETE	12"	4"
2	ASPHALT	12"	4"
3	GRAVEL	12"	4"
4	GRAVEL	12"	4"
5	GRAVEL	12"	4"

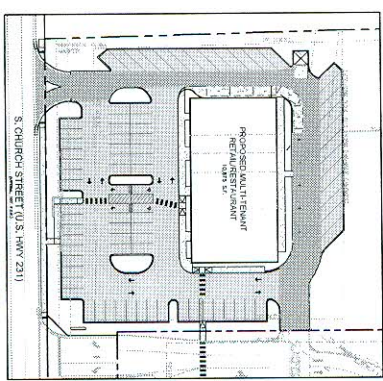
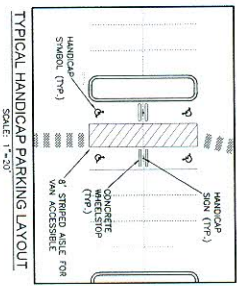

PAVEMENT LEGEND

- CONCRETE PAVEMENT
- CONCRETE MAUL
- HEAVY DUTY ASPHALT PAVEMENT
- LIGHT DUTY ASPHALT PAVEMENT

SCALE: 1" = 20'

NO. 10 SCALE

SITE DATA:

PROJECT INFORMATION:
 SUBMITTER: INNSBROOKE COMMONS
 2427 SOUTH CHURCH STREET
 CHATTANOOGA, TN 37408
 PHONE: (423) 249-1111
 FAX: (423) 249-1112
 CONTACT: W. MAGILL
 DATE: 09/03/2013

DESIGNER:
 RAGAN SMITH & ASSOCIATES, LLC
 1100 W. WOODWARD STREET
 CHATTANOOGA, TN 37408
 PHONE: (423) 249-1111
 FAX: (423) 249-1112
 CONTACT: W. MAGILL
 DATE: 09/03/2013

PROJECT INFORMATION:
 PROJECT NAME: RETAIL RESTAURANT
 PROPOSED SITE AREA: 4.275 AC (185,125 S.F.)
 PROPOSED SQUARE FOOTAGE: 10,875 S.F. (1.01 AC)
 ESTIMATED COST: \$2,500,000 (2013 \$)

PERMITS:
 PERMITS REQUIRED: 21 SPACES
 RESTAURANT (1 SP/100 S.F.)
 TOTAL: 21 SPACES
 49,063 SF (1.13 AC) +/-
 HANDICAP ACCESSIBLE (MINIMUM)

PREPARED BY:
 W. MAGILL
 DATE: 09/03/2013

NO CONTINGENTIAL STUDY HAS BEEN CONDUCTED ON THIS SITE. HOWEVER, THE DESIGN FOR THIS DEVELOPMENT IS BASED ON THE ASSUMPTION THAT THE EXISTING UTILITIES ARE AS SHOWN ON THE SITE PLAN. THE DESIGNER HAS CONDUCTED A VISUAL SURVEY OF THE SITE AND HAS NOTED THE PRESENCE OF UTILITIES IN THE AREA OF THE PROPOSED DEVELOPMENT. THE DESIGNER HAS NOT CONDUCTED A UTILITY LOCATIONS SURVEY AND HAS NOT OBTAINED ANY RECORD DRAWINGS OR RECORD COPIES OF RECORDS OF SURVEY OR RECORDS OF DEEDS, ADVERTISEMENTS, AND COORDINATION WITH THE LOCAL GOVERNMENT AND THE LOCATION OF THE COG/PAVE REQUIRED FOR THE DEVELOPMENT.

LEGEND:
 EXISTING UTILITIES: 411-4923734
 EXISTING UTILITIES: 411-4923734
 EXISTING UTILITIES: 411-4923734

DISCLAIMER:
 THE DESIGNER HAS CONDUCTED A VISUAL SURVEY OF THE SITE AND HAS NOTED THE PRESENCE OF UTILITIES IN THE AREA OF THE PROPOSED DEVELOPMENT. THE DESIGNER HAS NOT CONDUCTED A UTILITY LOCATIONS SURVEY AND HAS NOT OBTAINED ANY RECORD DRAWINGS OR RECORD COPIES OF RECORDS OF SURVEY OR RECORDS OF DEEDS, ADVERTISEMENTS, AND COORDINATION WITH THE LOCAL GOVERNMENT AND THE LOCATION OF THE COG/PAVE REQUIRED FOR THE DEVELOPMENT.

JOB NO. 07-064 **W.K. ORDER 9756**

DESIGNED: W. MAGILL

DRAWN: R. HIRSCH

SCALE: 1"=20'

DATE: SEPT. 03, 2013

REVISIONS:

DATE **DESCRIPTION**

INNSBROOKE COMMONS RETAIL CENTER
FOR
INVESTMENT PARTNERS, LLC

SOUTH CHURCH STREET @ INNSBROOKE BOULEVARD
 CITY OF MURFREESBORO, RUTHERFORD COUNTY, TENNESSEE

RAGAN SMITH & ASSOCIATES, LLC

LAND PLANNERS • CIVIL ENGINEERS
 LANDSCAPE ARCHITECTS • SURVEYORS

CHATTANOOGA
 1100 W. WOODWARD STREET
 CHATTANOOGA, TN 37408
 (423) 249-1111

C1.1